

# Acquisition: an index

AFTON WILKY





# ACQUISITION: AN INDEX

AFTON WILKY

ESSAY PRESS EP SERIES



#44

## ESSAY PRESS EP SERIES

In the Essay Press EP Series, we give extended space and time to some of our favorite authors currently developing new book-length projects.

## CONTENTS

*Series Editors* Maria Anderson  
Andy Fitch  
Ellen Fogelman  
Aimee Harrison  
Courtney Mandryk  
Victoria A. Sanz  
Travis Sharp  
Ryan Spooner  
Randall Tyrone

*Series Assistants* Cristiana Baik  
Ryan Ikeda  
Christopher Liek

*Cover Image* From a collection of family  
photographs, courtesy of  
Afton Wilky

*Cover Design* Courtney Mandryk

*Layout* Aimee Harrison

Introduction	v
Acquisition	2
Provenance	3
Inventory	4
Sorting	18
Indexing	23
Author Bio	36

## INTRODUCTION

*Acquisition: an index* is an excerpt from a book-length essay, *Reservoir*, which tells the story of Arthur Lee and Lillian Mae Gibson, two people displaced by the building and arbitration of Milford Lake in Kansas (the largest man-made body of water in the state). A cross between lyric-essay and micro-history, *Reservoir* embodies the rubble of this forgotten past through analogous textual structures, such as footnotes containing salient literary quotations, lists of debris in the area and short lyric collages made from a cut-up version of the manuscript. Piecing narrative together from newspaper articles, an archaeological report and a box of documents belonging to Arthur and Lillian Gibson, *Reservoir* traces parallels between physical, textual and grammatical sites of accrual: box, house, reservoir, archive, history, literature, person, pronoun and footnote. Seeking a means of writing that will also undergo the slippage it describes, *Reservoir* finds that in language, fractured at the level of sentences, paragraphs and/or page, which is fragile enough to approach an account of loss. Beginning with the arrival of a box of documents, *Acquisition: an index* examines the process of taking possession in both an archival and more general sense.



endless proximity Rendered. through sheets of paper, one  
might wish. transfer. holding those holding continued  
again. times moment, as row River light finding flatness  
abstracted. patterned rubble. opening events Objects having-been  
otherwise synapses tissue, limestone foundation; which,  
this plastered surface frames. What structure grows bursting  
Sometimes inwards. Holes could approach. Exponentia  
expands. emptiness shimmers. Reservoir. poured spreading  
evidence these blades oneself, Say hands; bursting  
weights catching someone. trade-off. operates occupies  
which handwritten moment Shimmers. close All [ ]  
indefinitely. involved

## ACQUISITION

At the end of telling this begins. Cut apart, one by one, its words begin again. Unwilling to end, they circle back. Reconfigure. Tell upon tell rendering further.

## PROVENANCE

All at once. Only a partial view. Each retina presented with splinters of letters cut from opaque cards. Holes which, when overlaid, would look like a word.

One letter at a time is the fullest extent to which the duplexity recedes. A binocular action between retinas.<sup>1</sup> Active, yet never resulting in complete integration.

By one standard this could be understood as a failure. The evidence of a limit relieves me. The presence of fracture impeding a word.

Foregrounded. Evidencing "binocular rivalry." Several successive integrations occur. Who can say when this is over?

---

<sup>1</sup> Davies, Peter. "The Role of Central Processes in the Perception of Visual After-Images." *British Journal of Psychology*. 64.3 (1973): 325–338.

# INVENTORY

A small box arrives, filled. An armful, 500 cubic inches, a small box of what's left. Stacked inside lies a miscellany: receipts, contracts, pay stubs, tax documents, a recipe box, the *Woman's Home Companion Cook Book* (1943 edition), several letters, two blank postcards, some photographs and two envelopes of negatives. A collection of remnants in which remittance gets mixed in with photograph. Telling of necessity. Loose sheets and carbon copies, opened envelopes and canceled postage. What was kept when so much got left behind. Its weight. What its weight has been stacked upon. All this arrives in a small, tightly taped box.

Tape of the box cut, its contents expands. The smell of yellowing paper rises, heavy, still hot from the sun.



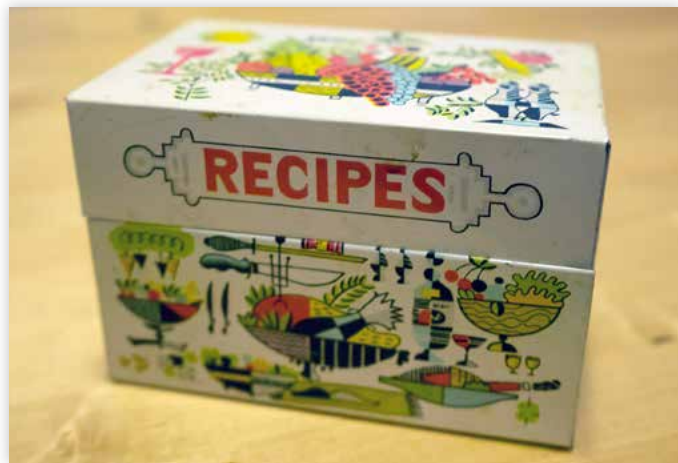

Marvelous Sweet Pickles

<p>1 gal. of medium cucumbers          1 gal. water          1 cup pickling salt.          1 tbsp. alum          1 tbsp. ginger          8 c. sugar          5 1/2 c. vinegar          2 2/3 c. water          1 ts. celery seed          1/2 box mixed pickling spices</p>	<p>Wash &amp; slice cukes. Place in a brine of the gal. water &amp; 1 c. salt. Soak in this for 4 days, stirring each eve. On 5th day, remove the cukes from brine, wash &amp; return to jar &amp; cover with the gal. water + 1 tbsp alum. Let stand overnight. The next morning drain the</p>
---	---



alum water from cukes. Place in a kettle + add, gal water + 1 tbsp ginger Boil for 10 min. While pickles are boiling make a syrup of remaining ingredients. Put spices in a bag. Cook til clear. Drain ginger water from cukes + pour the syrup on - continue boiling until they are transparent. Seal in jars.

51



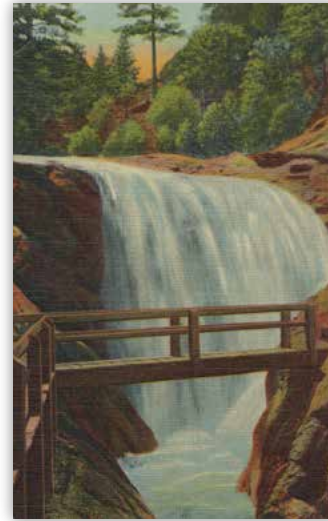
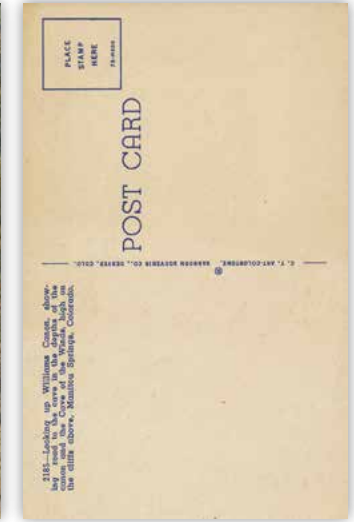
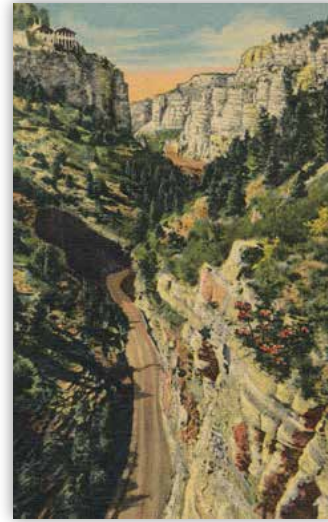
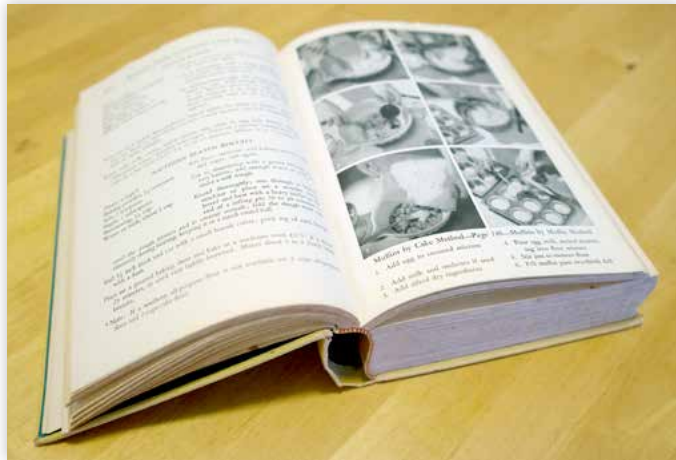
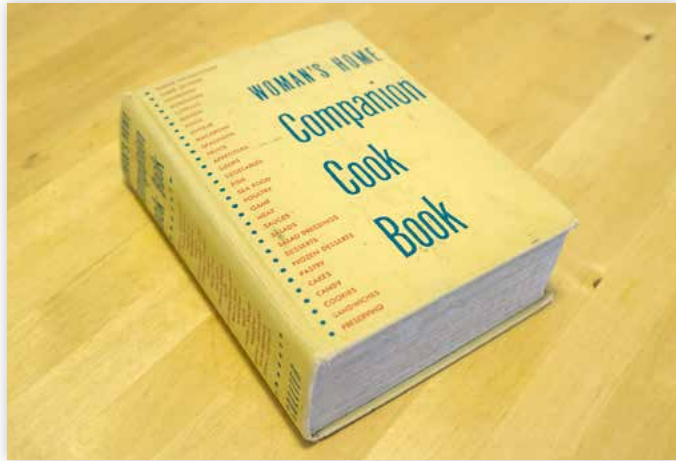

Recipes, postcards and photographs held onto. A sequence of expenditures pointing back to movement. Persons. Instants compressed into a series of numbers, transactions, snapshots. They indicate. Track.

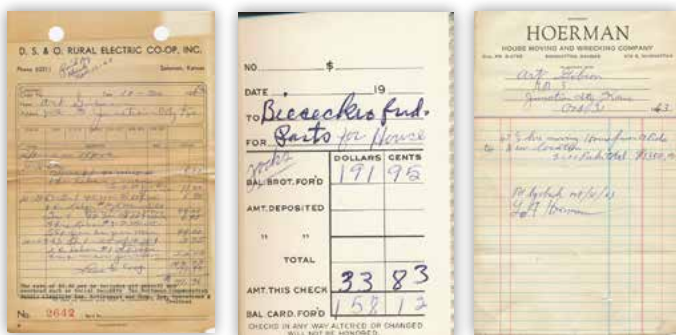
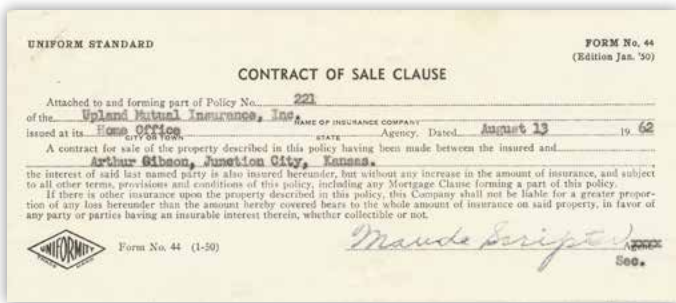
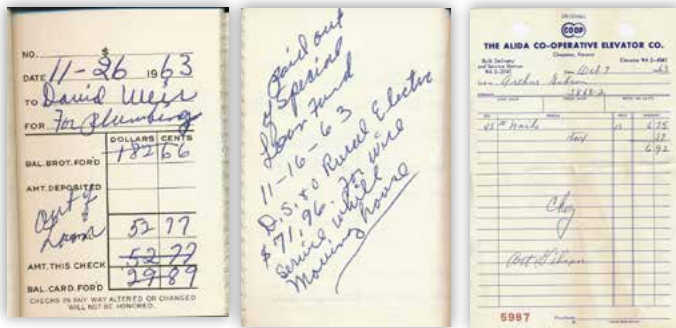

Snippets pointing towards hands, actions, movements. Expenditure becomes a receipt. Letters cross a distance, span delay, change hands. A person. Present, the light in such an instant, taking, a photograph. Packed in a box taped closed.





Laid upon paper, held up to the light, figures and forms glow within some of the negatives. There are so many people I don't recognize. There's so much I don't know and don't know how to decipher. I'm captivated by the sense of loss. By the evidence of fade. By the hint of form glowing in an otherwise blackened image. Traces of shoulders and cheeks. By the shadows holding a camera, protruding in from the edge of some of the frames. The way a photograph allows someone to make a mark in time. Their body displacing light. Their, there, they're. Mark recorded. Film. Light. To hold onto. Reaching

back. The way some positioned themselves before the camera as if to be entirely documented in this moment at this place.



So much may and does come between. Damage

etched across and through leaves behind jagged edges and gouged surfaces. Shots are frequently overexposed.

Film's sensitivity-threshold exceeded, faces and forms disappear into the blackened frames. Flatten back into nothing. Aperture compounded by the intensity of illumination in time. Sometimes having seeped beyond the edge of the frame. Film increasingly opaque. What all this means for the persons pictured. Figures. Literal shadows: the inverse of light displaced by form. Persons, places, moments cast upon film eroded to flatness by sun, a shutter held open too long, an aperture opened too wide. Not knowing it until it's too late.

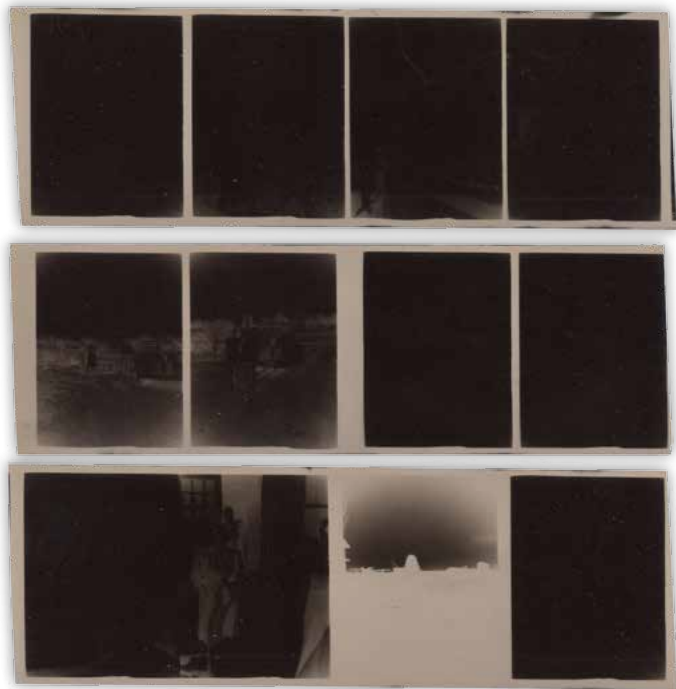

Fingerprints and dust evident. Scratched surface, a sketch of wear. Positioned. Sequenced. Located. Somewhere in the midst of receipts. A paper trail plotting. Action. Expenditure. Not a lens opening film to light present in a particular moment, but recording another kind of exchange. Receipts documenting with names and numbers who, when, where and how much. Not an encounter between one holding the camera and their subject. Currency. Canceled postage. Quantities, not degrees of brightness.

Pressure inside has softened the box. Unevenness of the paper stacks inside pressed against tape. Arthur Lee. Lillian Mae./Monkey Lou. Lil. Art. Traces so faint. Mere pointing. Documents, expenditures, photographs, receipts. Where are the hands in these pieces that follow? Their impulses pulsing amidst necessity. Long after the fact. After actions. Arthur laying down cash, signing his name. Dates marking movement. Fragments pointing. The arrays of experience they are tied to. A series of shadows overlaid. Through what might I approach this?

# SORTING

One or several scraps at a time, each stacked on top of the rest. Shuffled through again as recourse. No more than the proximity of material, haphazard at best. A staggered figuration. And yet I, this, an intersection is garnered. To trace it, to follow it here and record all this.

As a verb, the word "trace," refers to an act of extension outwards from oneself into the past or the future.<sup>2</sup> The instrument of such extension may

---

## 2 Trace (v):

To pass along or over, tread; to travel over or through; to take one's course, make one's way, to proceed; to proceed in a line, course or track.

To follow the course, development or history of; to make out and follow (with the eye or mind) the course or line of something; to make out (worn or obscure writing); to discern, decipher.

To mark, make marks upon; to draw an outline or figure of; also, to put down in writing, to pen; to copy (a drawing, plan, etc.) by following the lines of the original drawing on a transparent sheet placed upon it.

To make a plan, diagram, or chart of something existing or to be constructed; to mark out the course of something on, or by means of, a plan or map.

*(Oxford English Dictionary)*

be one's body, mind and/or pen. From the Latin *tractus* (a drawing, dragging, trailing, crawling; a train, track, course; to proceed in a line, course, or track), to trace is not merely an attempt to copy, but a means of moving through and engaging closely with that which is distant or unfamiliar to oneself. It requires re-walking, doing again. It minimizes the distance at which one might hold struggle.

To endeavor doing as they have done, thinking as they have thought. To mirror with myself. In some way. Become this. And the impossibility of ever really being able to do so. As an act of the mind, tracing involves efforts to discern or decipher. It projects the past into the present, each rendering marked; every account making anew. To proceed in a line, sentence upon sentence, not knowing.

[ ] stood where Milford Lake would stand. A reserve to the point of bursting.

They stood where Milford Lake would stand. A reserve to the point of bursting.

She stood where Milford Lake would stand a reserve to the point of bursting to the point of bursting a reserve which would stand where she stood.

He stood where Milford Lake would stand reserved to the point of bursting.

Their house stood where Milford Lake would stand a bursting reserve point to bursting.

To bursting it would stand a reserve where their house stood. Milford Lake to the point of bursting.

Bursting stood where she, he, they stood. A lake would stand. A Milford Lake would stand. Bursting where he, they, she stood. Where she, he, they stood, it would stand. A reserve. To point bursting. Milford Lake would reserve. It would stand. It would stand where [ ] stood.

A house, a person echoes. Shapes what takes place inside. Words collected and collecting.

# AUCTION

REAL ESTATE SELLING AT 2:30 PM

SUNDAY, OCT. 5 [1980]



**STARTS 12:00 NOON — LUNCH**  
Due to poor health I will sell the following located NW of JUNCTION CITY, KS, on the west side of MILFORD LAKE — Take Hwy. 77 & 244 ten miles to Laurel Canyon, then continue 1 mi. north and 360 yards west on Geary & Dickinson County line. Watch for signs.



The home consists of 4 bedrooms upstairs, 1 bedroom, kitchen, living room, dining room, laundry room, bath downstairs, boiler floor furnace, full basement, well and septic tank.

**Legal Description** — Tract beginning 694.5 feet West of Southeast corner, thence West 208.71 ft., thence North 208.71 ft., thence East 208.71 ft., thence South 208.71 ft. to point of beginning, in Section 3, Township 11, Range 4, Fragrant Hill Township, Dickinson County, Kas. One acre more or less.

**Taxes** — \$48.14. Taxes for 1980 will be paid by the seller and all prior years.

**Terms** — \$2500 down day of sale, balance when merchandise lots and warrants deed are delivered. Possession will be given when all monies are paid.

Announcements and statements made at the sale will take precedence over all printed information.

**OPEN HOUSE — THURSDAY, SEPT. 25, 5.00 to 7.00.**

For more information call Earl M. Brown, Auctioneer, 913 752-2266.



**HOUSEHOLD**

Signature 21' 2-door frostless refrigerator  
Coldspot older model refrigerator  
Mag. Chef 40' LP gas range  
Coronado automatic washer  
Signature electric dryer  
Kalamore dish washer  
Regina floor polisher; Lewyt sweeper; Universal sweeper  
Coronado humidifier;  
Singer cabinet electric sewing machine  
Singer treadle sewing machine  
Admiral TV & entertainment center  
Admiral B&W 17" TV & stand; small table radio  
5 pc. waterfall bedroom suite with box spring & mattress, very good  
Hollywood bed with good box springs & mattress  
Jenny Lind bed; 2 iron beds; pine chest of drawers  
Antique leather fading couch; large divan; 3 recliners  
2 occasional chairs; 2 large rockers  
round library table; 4 end tables; desk & seat  
9 book shelves and many books  
Large drop leaf dining table, buffet & chairs  
Chrome dinette set with 6 chairs  
Kitchen serving table and chair  
Step stool; 2 metal utility cabinets  
2 clothes hampers; clothes rack  
Antique oak frame mirror; 2 large wall mirrors one oval  
3 rugs approx. 9x12; oval braided rug  
Round circulating fan; osc. fan; 20" box fan  
Small electric space heater; 2

floor lamps; 4 table lamps; swag lamp  
Kerosene lamp & lantern; 2 gal. stone churn; fruit jars.

**DISHES & MISC.**

Set of 5 Windsor Melco 22K gold trim Japanese china  
40 hand painted cup & saucer sets  
3 round covered butter dishes; 5 water glass sets  
Pink depression cookie jar; 3 pink depression clatters  
2 bowls and Miss America creamer & sugar  
Lots of glass & china; pots & pans  
Mixer; cookie jar; cast iron ballies  
Pillows; bedding; food grinders, etc.  
Granite roaster & large pail; hamster sets  
Hand carved Oriental box set; carved wood tea set  
Lots of Avon bottles, whiskey decanters & glass insulators  
2 large glass plant terrariums  
Blende-weld spiral plant stand; card table; TV tray set  
3 Model T Ford picture prints and many other nice pictures  
4 suitcases; picnic basket; gun rack; banjo; 5 food cooler chests; 3 metal lawn chairs; lots of fishing rods, poles, reels, dip nets, tackle boxes, minnow pails etc.; 8 amp battery charger; auto-tomative valve grinding & seating set; lots of good carpenter & garden tools; water-soluble cords; vise; saw horses; block & tackle and other misc. shop items; hand sprayer; lawn cart; barbeque; large pile of hollow tile blocks and many more items too numerous to mention.

**Terms** — Cash Not Responsible For Accidents

**MRS. ART GIBSON, OWNER**

Everett Sheets, Clerk

Earl M. Brown CAJ — Auctioneers — Mill Anderson CAJ  
Phone 913 752-2266 Phone 913 533-7345  
789 North Madison, Box 68, Junction City, Kansas 66441.

## INDEXING

Something waving between is and then.<sup>3</sup>

All my estate a sentence, a grammar, a house held ours.  
Is preserved—it marks our invention, possibility, hands.  
(An address. Picture a house in an address.) Reread  
in what tense? A house, a preference; a tradition, a  
raindrop can be heard. I begin again to begin again  
and go, spreading wide my narrow hands.



Circa 1963, a young girl criss-crossed her grandparents' yard combing through blades of grass with a horseshoe magnet tied to a string. Her brother was with her, giant roofing nails snapping to his magnet. They'd peel the nails off, filling up coffee cans. That summer was spent dismantling porches all over town. I suspect neither the girl nor her brother saw the house lifted away from its foundation, though they gathered the nails from its porch.

Two magnets, dragged through the grass, collected the nails of the house. Later, she'll remember the house for its swaths of mahogany and curving

---

Dickinson, Emily. "F466A – I dwell in Possibility." *The Poems of Emily Dickinson*. Ed. R.W. Franklin. Cambridge: Belknap Press of Harvard University Press, 1998:

I dwell in Possibility –  
A fairer House than Prose –  
More numerous of Windows –  
Superior – for Doors –  
Of Chambers as the Cedars –  
Impregnable of eye –  
And for an everlasting  
Roof  
The Gambrels of the Sky –  
Of Visitors – the fairest –  
For Occupation – This –  
The spreading wide my  
narrow Hands  
To gather Paradise –

staircase, for the black walnut tree overhanging the driveway.

The structure "consists of four bedrooms upstairs, one bedroom, kitchen, living room, dining room, laundry closet, bath downstairs, butane floor furnace, full basement, a well and septic tank." There is no known record of construction. No when, nor where, just a residue of patterned movements; its array coats and fills.

...glass and china, pots and pans,  
mixer, cookie jar, cast iron skillets,  
pillows, bedding, food grinders,

---

Stein, Gertrude. "Arthur a Grammar." *How to Write*. West Glover: Something Else Press, Inc., 1973. 61:

House.

This is a curtain it can also be a place for which there is a preference.

Consider a house.

In an address consider a house in an address.

A vocabulary is not an annoyance when they see lilies over roses.

A grammar has nothing to win her as foliage is priceless.

Consider.

House in a house.

A house held ours.

How has a house made a distinct impression.

Come with and when.

Leave grammar alone with feeling.

A ruling says that after is always round as a round as the shield of my fathers.

A rain drop can be heard.

Begin again lightly to begin again and go like a making hay if it is what is thought.

granite roaster, canister sets, carved wood tea set, plant terrariums, black metal spiral plant stand, card table, TV tray set, three Model-T Ford picture prints, four suitcases, picnic basket, gun rack, banjo, five food-cooler chests, three metal lawn chairs, lots of fishing rods, poles, reels, dip nets, tackle boxes, minnow pails, eight-amp battery charger, automotive valve grinding and seating set, lots of good carpenter and garden tools, extension cords, a vise, sawhorses, block and tackle and other miscellaneous shop items...

Objects and signs of their wear situate. They structure a mnemonics of nothing-to-spare. Until their payments equaled its purchase price, Arthur Lee and Lillian Mae rented this house. It stood where Milford Lake would stand, a point of investment on the surface of the land. Days and years of circling and doing across its planes. It is built of this, though one might also deny that this is so. A foundation is

---

Howe, Susan. "Melville's Marginalia." *The Nonconformist's Memorial*. New York: New Directions, 1993. 98:

All my  
estate  
or property  
all  
quotations  
from  
books "

pulled together by a becoming situation. The house is not the land, purchased out from under it, the two in a phase of contact. The bursting reaches me here, now, half a century after. I see the house, occupy the house. I am finding its edge. It follows me and expands. An intent dragged across a surface, tracing unto its trace. A doubling back at once into forward and shadow. Fall and enjoy it. —words collected and collecting—

A foundation lifted might become anything. Be set down any way. A residual shaped backwards of function. Displaced out of one's body. Inside and outside curved in such a way as to be neither, here nor there. So as to present themselves as otherwise. House. Person. Reservoir. Man-made. Here.

---

Snow, Carol. *Placed: Karesansui Poems*. Denver: Counterpath Press, 2008. 47:

OVER

should you want to return here—"preserved the ticket  
—the very"—litany—reread (in what tense?)  
"reread"—at/  
present—Period.—"What is a sentence."

"What is a sentence. They sent preserves."

1) "To" 2, Epigraph) Gertrude Stein, "Sentences"

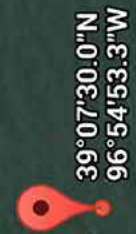

---

Harryman, Carla and Lyn Hejinian. *The Wide Road*. New York: Belladonna, 2010. 21:

[ ] "isn't a received tradition. It's our invention."

T. 10 S

CLAY

SMOKY HILL

T. 11 S  
CO. DICKINSON T. 11 S

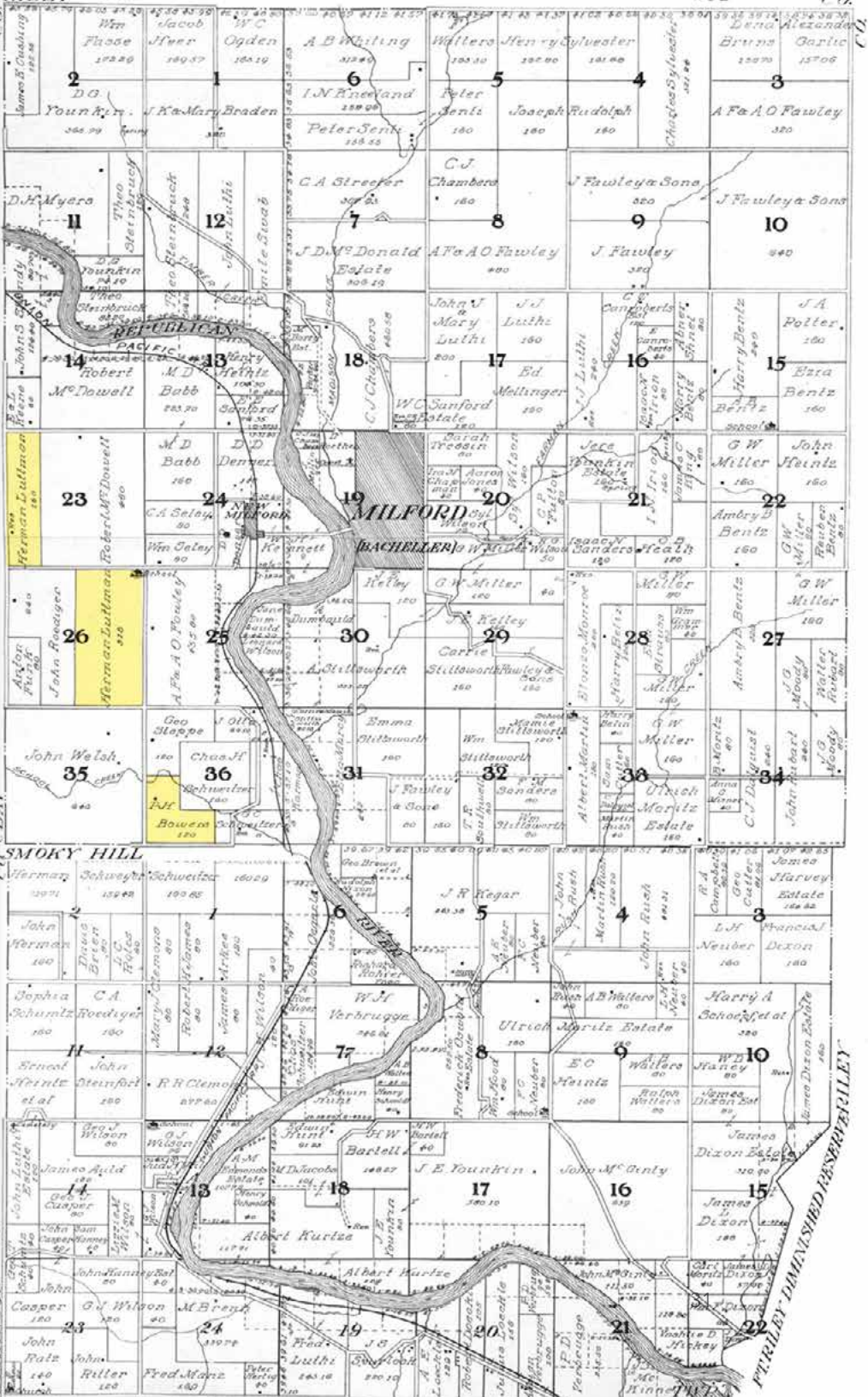
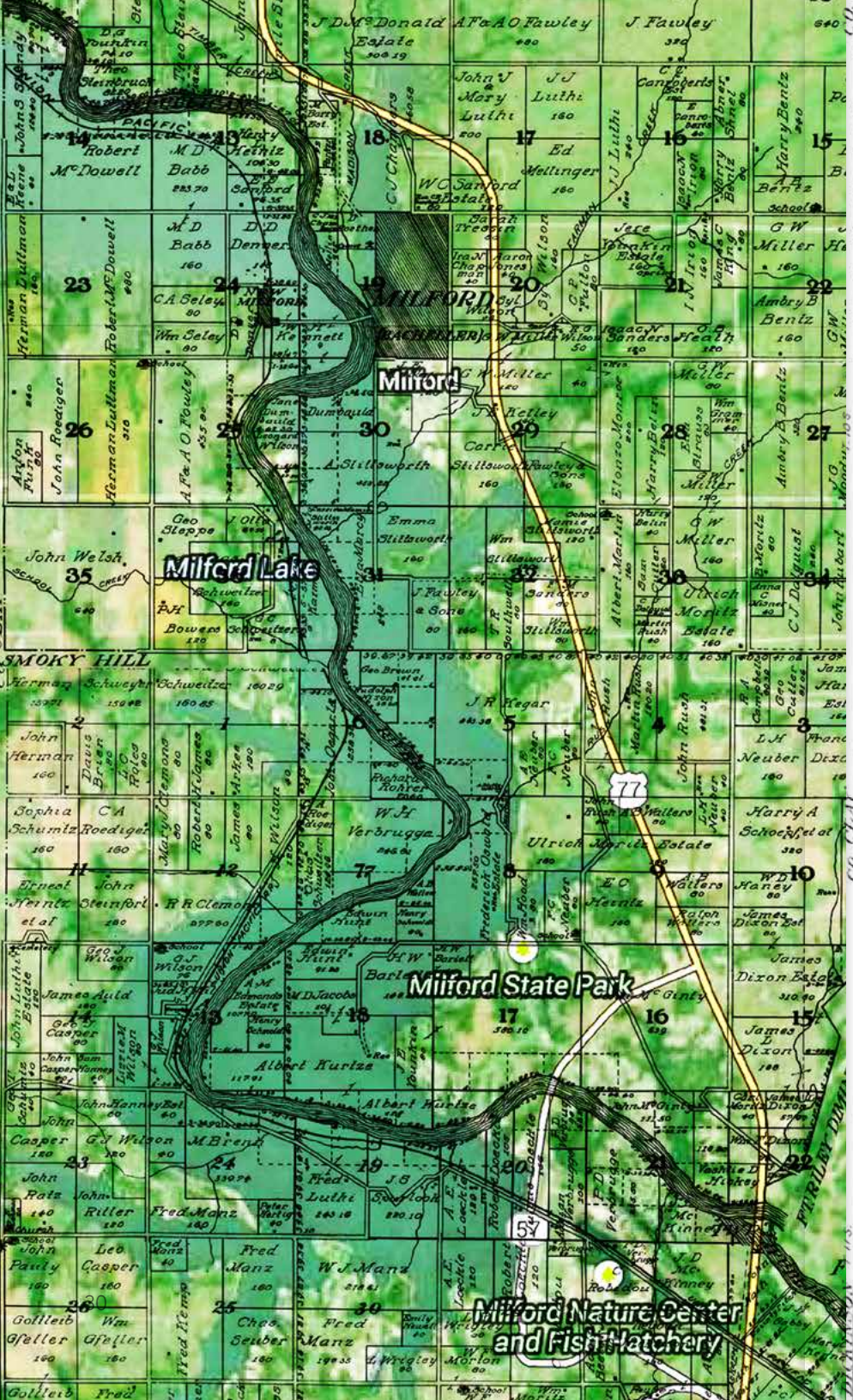

# Barren But Rich

The lunar-looking landscape of parts of the Voss oilfield southwest of Plainville appears like a land forgotten both by time and by man.

Shale outcroppings, some tilted by erosion and prehistoric upheavals, rear skyward here and there, adorned only by cactus and scattered. Sharp, crusty shale is underfoot; shale and sandstone crumble from the banks of dry gullies and shallow canyons winding through the area.

Vegetation is limited to a few of the more hardy specimens of plants struggling for footholds in the rocky earth; cattle don't step through the area, because the vegetation is too thin.

The area's richness lies beneath its barren surface. The Voss field is one of the larger oil producing areas in North-Central Kansas.



## Land That Time Forgot

Only layer upon layer of shale, some upended into sharp spires, and a few hardy weeds are found in the Voss area. Heat reflected from the shale causes the place to become bitterly cold in winter.

## Schurle, Duwe Boost PC

LAWRENCE — Two North Central Kansas are among 10 members of a University of Kansas committee to highlight interest in the Voss area.

Consulice members include Aris W. Schurle, son of Mr. and Mrs. W. Schurle, Green, and Richard K. Duwe, son of Mr. and Mrs. J. R. Duwe, Loock.

## Oil News

# Saline Activity Is Slow Drillers Busy In North

Saline County oil play continued in the doldrums of the coast. The test in one well southwest of North Central and Northwest Kansas, and one mile north of the town of Lincoln County, drilled in 1961, was treated with 500,000 gallons of water. The test is "a mile to the south of the Parker field, one mile south of the Parker field, one mile south of the Parker field."

## Gove County Gift Highway Brings Flock Of Problems

GOVE CITY—Gove County has been given a fine chincy other. The county and township are faced a dilemma. If they have a fine blacktop surface, the maintenance machinery, the cost will be high on roads will be for maintenance of the same. It is a public surprise and Gove County did US40 highway.

## Autopsy Held In Abilene Slaying

ABILENE — An autopsy on Mrs. Isaac Pyle, Abilene, verified previous medical examination which indicated she had been shot four times in the head.

## 1000th Bab Hospital At

DR. FRANCIS — The 1000th birth of a child in the Cheyenne County Hospital here.

## FHS Home Study Courses Popular

HAYS — Home-study courses, course courses offered by F. Hays State College are increasing in popularity.

4



**Just Waiting Patiently**  
Everything in this picture will be razed when work starts on the Milford dam and reservoir. The city of Wakefield is just waiting, its future uncertain. (Journal Photo)

4 "State Action Needed Before Wakefield Knows Its Future." *The Salina Journal*. 19 Feb 1961: 16. [Prev.] *The Salina Journal*. 9 Sept 1962: 43.

Howe, Susan. "The Nonconformist's Memorial." *The Nonconformist's Memorial*. New York: New Directions, 1993. 7:

As if all history were a progress...A single thread of narrative...

Dickinson, Emily. "F563A — The brain within its groove." *The Poems of Emily Dickinson*. Ed. R.W. Franklin. Cambridge: Belknap Press of Harvard University Press, 1998:

The Brain, within its Groove  
Runs evenly — and true —  
But let a Splinter swerve —  
'Twere easier for You —

To put a Current back —  
When Floods have slit  
the Hills — And scooped a Turnpike  
for Themselves —  
And (blotted out • showed away —) trodden out the Mills —

## Mountains Of The Moon

This isn't a lunar landscape, it's part of the Voss oilfield southwest of Plainville, where some of the most weird rock formations in Kansas can be found.

The Salina Journal

# Central And Northwest News

Harold Wilks, District Editor

# Future Of Milford Uncertain For Second Time In 30 Years

MILFORD — For the second time in little more than 30 years, residents of Milford are awaiting a decision that will affect the future of their town.

## Northwest Road Projects

# \$1 1/2 Million Bids Opened At Norton

NORTON — Highway construction bids totaling \$1,465,200, mostly for projects in Northwest Kansas, were opened at Third Highway Division offices here.

## Four Charged With Burglaries

DETROIT — Four Tulsa youths were bound over to district court on charges connected with break-ins at four Tulsa stores.

## Street Bazaar

LEON COUNTY — 34 miles parade modification, Clarin Blaine, Great Bank, B&M, Russell — Bridge, King Construction Co., \$20,000.

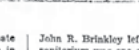
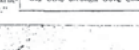
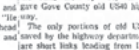
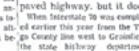
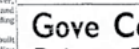
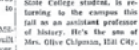
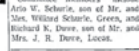
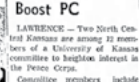

## It Stood Here

Little but two fence pillars and an ornate street light remain of the Brinkley sanitarium in Milford. The sanitarium was torn down after Dr.

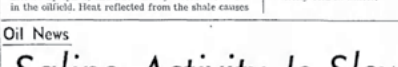

John R. Brinkley left Milford. In his heyday, the sanitarium was one of Milford's largest employers.

Alida will be inundated with water. Will cease to exist.

Parts of Milford and Wakefield will be subsumed.

This will echo.<sup>5</sup>

---

<sup>5</sup> Stein, Gertrude. "Saving the Sentence." *How to Write*. West Glover: Something Else Press, Inc., 1973. 20:

It is an hour after they came.

May be with them.

No doubt may be with them.

No doubt may be with them no doubt may be.

May be with them may be. May be they may be.

It is easy to hide a hope.

Have meant.

A little goes a long way.

How many houses are there.

There is a house near where there is a bridge. They were willing to be there.

Hours out of it in adjoining them.

It is why forty is not arithmetic with wonder.

Any time that they go they stay. How are ours with lain for it.

It is not that it has been inhabited.

Regret unadorned and far reaching. Intention dragged across a surface *Via I-35 N 13 hrs 24 min (903 mi)*, preserved for a later date, recalled upon demand *Get on I-10 W from Nicholson Dr 7 min (3.5 mi)*. A means of becoming somehow otherwise than this *Follow I-10 W to 9 Take exit 151 from I-10 W 3 min (3.4 mi)*, its cut following the periphery of one's hand, one's body *Get on I-49 N/US-167 N from US-190 W 53 min (52.9 mi)*. Its line in infinite expansion *Continue on I-49 N to Harrison County Take exit 628 from I-20 W 2 hrs 49 min (208 mi)*. 900 miles, 13 hours beginning and ending with cut *Get on US-271 N/US-271 BYP N/US-70 BYP W in Choctaw County from TX-49 W 2 hrs 29 min (150 mi)*, a projection on paper. *Continue to Okmulgee County 1 hr 31 min (108 mi)* Arthur and Lillian *Continue onto US-75 N*, the shift of the surface beneath them. *Follow US-412 W and I-35 N to US-77 N in El Dorado Take exit 76 from I-35 N 2 hrs 50 min (204 mi)*. Invisible beneath the projection *Follow US-77 N to your destination in Milford 1 hr 31 min (94.5 mi)*. The weight of feet and many small whispers.

## AUTHOR BIO



**Afton Wilky** is a multi-disciplinary artist. Her work combines writing with sound, digital media and book arts. She is the author of *Clarity Speaks of a Crystal Sea* (Flim Forum Press, 2014). Her work is in or forthcoming from journals such as *Black Warrior Review*, *[out of nothing]*, *Siren*, *TAB*, *textsound*, *Word for/Word* and *Jacket2*. She is the managing editor of *The Volta*. Her website and blog are at [aftonwilky.com](http://aftonwilky.com).



Essay Press is dedicated to publishing artful, innovative and culturally relevant prose. We are interested in publishing single essays that are too long to be easily published in journals or magazines, but too short to be considered book-length by most publishers. We are looking for essays that have something to say, essays that both demand and deserve to stand alone. We particularly welcome work that extends or challenges the formal protocols of the essay, including, but not limited to: lyric essays or prose poems; experimental biography and autobiography; innovative approaches to journalism, experimental historiography, criticism, scholarship and philosophy.

Essay Press, like other small independent presses, needs support from its committed readers! Please consider [donating to Essay Press](#), so we can continue to publish writing that we and our readers admire.



